

# **INITIAL RECEIPT**

**United States Department of the Interior  
Bureau of Land Management  
DIV OF LANDS, MINRLS & ENERGY  
ONE N CENTRAL AVE  
PHOENIX, AZ 85004 -4427  
Phone: 602-417-9200**

Receipt	
No:	4707276

**Transaction #:** 4831673  
**Date of Transaction:** 03/05/2020

CUSTOMER:	
CARL J WARMAC 16126 N 159TH CT SURPRISE,AZ 85374-5867 US	

LINE #	QTY	DESCRIPTION	REMARKS	UNIT PRICE	TOTAL
1	1.00	LOCATABLE MINERALS / MINING CLAIMS-NEW,UNADJUD, ONE OR MORE AUTH NOS / NEW MINING CLAIM PROCESSING FEE CASES: AMC459460/\$20.00		- n/a -	20.00
2	1.00	LOCATABLE MINERALS / MINING CLAIMS-NEW,UNADJUD, ONE OR MORE AUTH NOS / NEW MINING CLAIMS LOCATION FEE CASES: AMC459460/\$40.00		- n/a -	40.00
3	1.00	LOCATABLE MINERALS / MINING CLAIMS-NEW,UNADJUD, ONE OR MORE AUTH NOS / NEW MINING CLAIMS MAINTENANCE FEE CASES: AMC459460/\$165.00		- n/a -	165.00
4	1.00	LOCATABLE MINERALS / MINING CLAIMS-NOT NEW-UNADJUD,ONE AUTH NO. ONLY / MINING CLAIM MONEY RECEIVED CASES: AMC459460/\$15.00	2020 NOI/1	- n/a -	15.00
<b>TOTAL:</b>					<b>\$240.00</b>

**PAYMENT INFORMATION**

NOTE: Items will appear on credit card statement as "Bureau of Land Mgmt CO".

1	AMOUNT:	240.00	POSTMARKED:	N/A
	TYPE:	CREDIT CARD	RECEIVED:	03/05/2020
	NAME:	WARMAC, CARL J 16126 N 159TH CT SURPRISE AZ 85374-5867 US		
	CARD NO:	XXXXXXXXXXXX7046	AUTH CODE:	040413
	NAME ON			

**ENTERED**  
**MAR 12 2020**  
BY: *Ram*

CARD:	CHRISTINA M WARMAC
SIGNATURE:	

REMARKS

This receipt was generated by the automated BLM Collections and Billing System and is a paper representation of a portion of the official electronic record contained therein.

# **CORRESPONDENCE**

# **TRANSFERS**

**MAINTENANCE FEES**  
**WAIVERS**  
**POL/NOI**

# **MISCELLANEOUS**

**LOCATION NOTICES**  
**AMENDMENTS**  
**STATUS SHEET**  
**GEO REPORT/MTP**



# MINING CLAIM STATUS REPORT - Assessment Year 2020

Data Entered: 3/12/2020

MTP Checked By: REP  
GEO Checked By: \_\_\_\_\_

LEAD SERIAL NUMBER: AMC \_\_\_\_\_ thru AMC \_\_\_\_\_

### NUMBER OF CLAIMS & TYPE:

### CHARGES:

- \_\_\_\_\_ LODE
- ✓  PLACER
- \_\_\_\_\_ ASSOCIATION PLACER
- \_\_\_\_\_ MILL SITE
- \_\_\_\_\_ TUNNEL SITE

Processing Fee @ \$20 = \$ 20

Location Fee @ \$40 = \$ 40

Maintenance Fee @ \$165 = \$ 165

Add'l Maint Fee for Assoc Placer = \$ \_\_\_\_\_

**SUBTOTAL** \$ 225.00

TOTAL ACREAGE: 20 Per Claim  
(Placer Only)

NOI 2020 Other Fees \$ 15.00

Other Fees \$ \_\_\_\_\_

NUMBER OF LOCATORS: 1

**TOTAL** \$ \_\_\_\_\_

DOCUMENTS RECEIVED VIA: Over-the-Counter  Mail  **TIMELY FILED:** Yes  No

LEGAL DESCRIPTION: T 10N R 50W SEC 33

T \_\_\_\_\_ R \_\_\_\_\_ SEC \_\_\_\_\_

T \_\_\_\_\_ R \_\_\_\_\_ SEC \_\_\_\_\_

T \_\_\_\_\_ R \_\_\_\_\_ SEC \_\_\_\_\_

T \_\_\_\_\_ R \_\_\_\_\_ SEC \_\_\_\_\_

BLM  FOREST SERVICE  \_\_\_\_\_ SUBJ TO PL 359: Yes  No

WILDERNESS AREA  \_\_\_\_\_

SPLIT ESTATE: N/A  SX  PX  OTHER  \_\_\_\_\_

SRHA  Was proper Notice filed if located on SHRA Land? Yes  No

### RECONVEYED MINERALS ON BLM LAND REQUIRE OPENING ORDER FROM 1944 TO 1993:

Open to Entry On \_\_\_\_\_ N/A

COMMENTS/STATUS: VOID  PARTIALLY VOID  PVT MINERALS  WITHDRAWN LANDS

OTHER  \_\_\_\_\_

Claimant acknowledges that portions of the following claim(s) site(s) may be void or voidable.

Printed Name of Claimant \_\_\_\_\_ Signature of Claimant \_\_\_\_\_

\*\*\*\*\*FINAL ADJUDICATION\*\*\*\*\*

DATE \_\_\_\_\_ INITIALS \_\_\_\_\_



See below

LOCATION NOTICE FOR PLACER MINING CLAIM

Amendment BLM Serial # \_\_\_\_\_

NOTICE IS HEREBY GIVEN that the Humblebug

\_\_\_\_\_ placer mining claim has been located by

Carl J. Warmac Jr. whose current mailing

address is 116126 N. 159th CT

Surprise AZ 85374

RECEIVED  
BLM AZ STATE OFFICE  
2020 MAR -5 A 10:37  
PHOENIX, ARIZONA  
BLM  
Date  
Stamp

The general course of this claim is North / South and it is situated in Yavapai  
County, Arizona. This claim is 1320 feet in length and 1110 feet in width.

20 Total Claim Acreage. This claim runs from the location monument on which this location notice is  
posted at the NE corner of the claim approximately 20 feet in a S direction to the  
N end line and 20 feet in a W direction to the E end line. This claim is  
marked by four monuments, one at each corner of the claim.

The location monument on which this notice is posted is situated within Section 33, Township  
10 N, Range 5 W, Gila Salt River Base and Meridian, Arizona. This claim encompasses  
portions of the following legal subdivision(s) if located by legal subdivision or the following quarter section(s),  
section(s), Township(s) and Range(s) E 1/2, NE 1/4, NE 1/4, S. 33,  
T. 10 N, R. 5 W, Gila Salt River Base and Meridian, Arizona.

The locality of this claim with reference to some natural object or permanent monument and additional information  
(if any) concerning its locality are as follows: \_\_\_\_\_

\_\_\_\_\_ The above information is shown on the attached map.

DATED AND POSTED on the ground this 20 day of Dec., 2019.

LOCATOR(s)  AGENT

Print Name(s) Carl J. Warmac Jr

Signature(s) [Signature]

Form MCF102  
Revised July 2014

AMC459460

MINING CLAIM MAP

Lode ( ) Placer (●)  
Millsite ( )

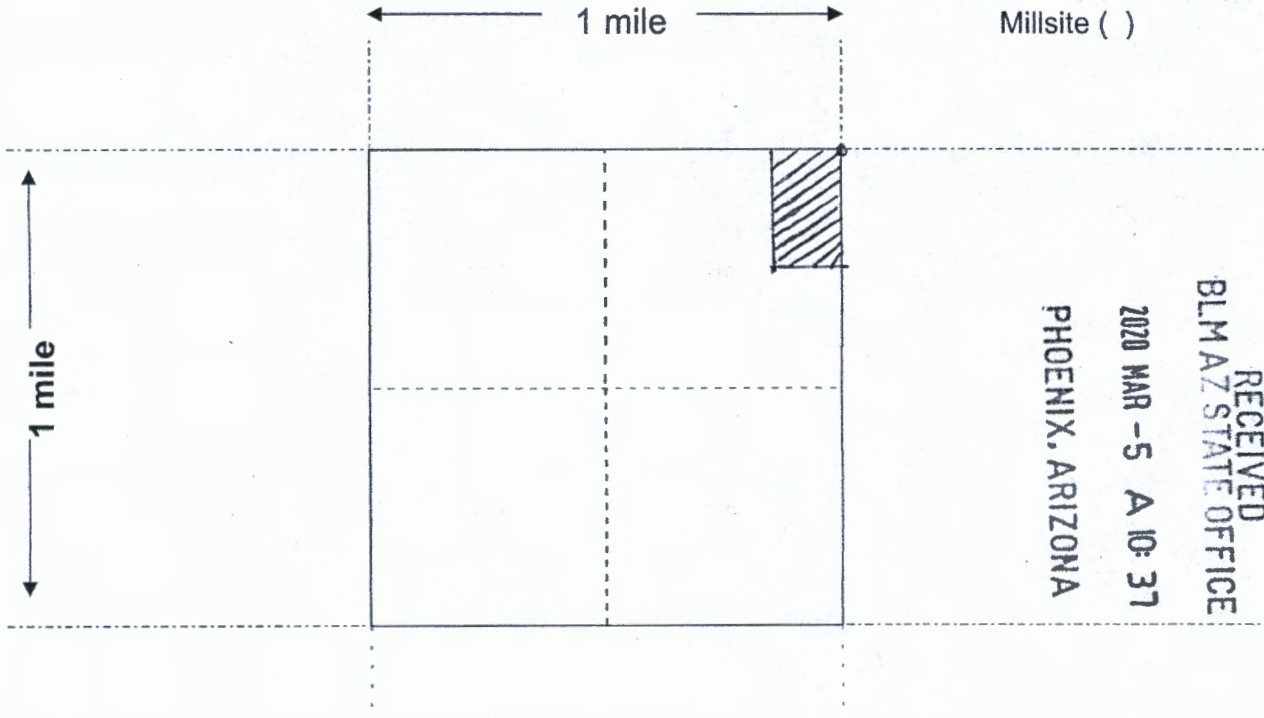

RECEIVED  
BLM AZ STATE OFFICE  
2020 MAR -5 A 10:37  
PHOENIX, ARIZONA

Scale: 1" = 2000 feet



- The above map depicts the Humblebug mining claim, which is located in Section (s) 33, Township 10 N, Range 5 W, Gila and Salt River Base and Meridian, Yavapai County, Arizona. Total claim acreage is 20 acres
- The type of corner and location monuments used are as follows: 1 1/2 inch PVC stakes
- The bearings and distances in degrees and feet between claim corners and to a public land survey monument are as depicted on the map.
- If the claim is a placer or millsite claim with exterior limits conforming to legal subdivisions of the public survey, provide a legal description of the claim E 1/2, NE 1/4, NE 1/4, S. 33, T. 10. N., R. 5W, GSRM

AMC459460

Form MCF100a  
Revised July 2014

This form is available from the Arizona Geology Survey and may be reproduced.

Date and Time Run:  
3/12/2020 3:55:33 PM

Page 1 of 1

DEPARTMENT OF THE INTERIOR  
BUREAU OF LAND MANAGEMENT  
Case Recordation

**Geographic Report with Land**

Disposition is equal to **AUTHORIZED , CANCELLED , EXPIRED , PENDING , REJECTED , RELINQUISHED ,  
WITHDRAWN**

**and Meridian Township Range Section is equal to 14 0100N 0050W 033**

**and Admin State is equal to AZ**

**NO WARRANTY IS MADE BY BLM  
FOR USE OF THE DATA FOR  
PURPOSES NOT INTENDED BY BLM**



DEPARTMENT OF THE INTERIOR  
BUREAU OF LAND MANAGEMENT  
Case Recordation  
Geographic Report with Land

Admin State: AZ  
Geo State: AZ

Serial Number	Total Case Acres:	Case Type	Case Disp	Mer	Twp	Rn	Sec	Sur Type	Sur Nr	Suf	Sub Division	Act P end
AZA 023556	29.900	28 1001	AUTHORIZED	14	0100N	005W	033	ALLI			E2NW,N2SE;	
	29.900							MNR			SWSWNE;	

